

Figured dimensions only are to be taken from this drawing.  
All dimensions are to be checked on site before any work is put in hand.  
IF IN DOUBT ASK.

CDM:  
Hazard Elimination & Risk Reduction has been undertaken and recorded where appropriate, in accordance with the requirements of "The Construction (Design and Management) Regulations 2015" and the associated "Industry Guidance for Designers"

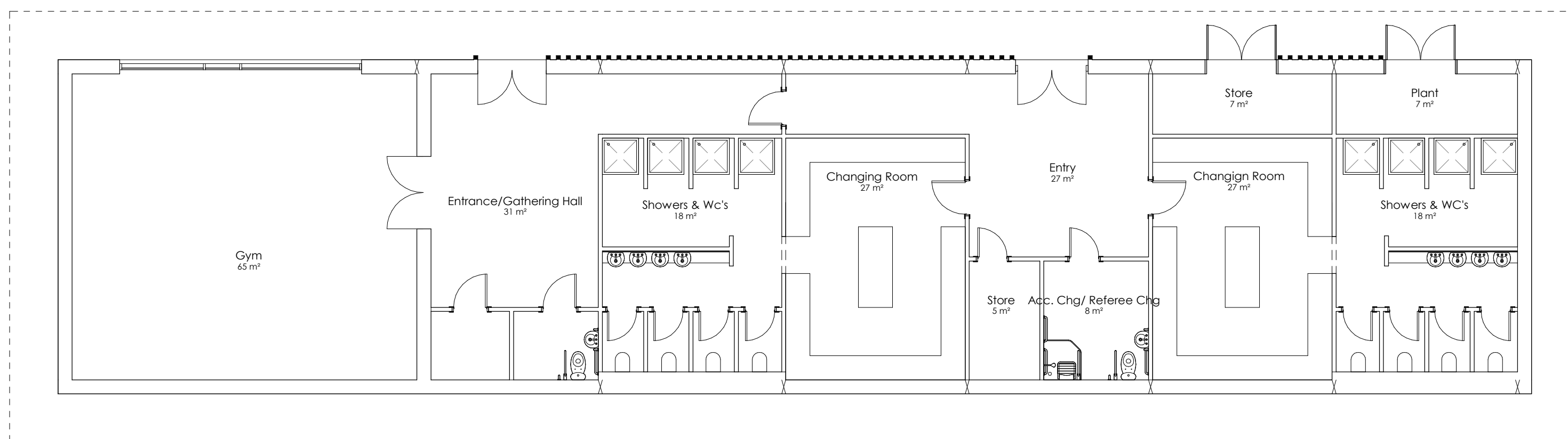
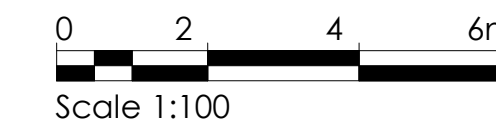
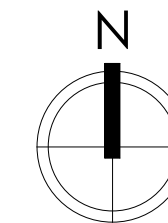

## Ground Floor Plan

Scale - 1 : 100

Rev	Description	Date



**COLIN ARMSTRONG**  
ARCHITECTS

Lyle House, Fairways Business Park,  
Inverness IV2 6AA

T : 01463 712 288  
W : www.colinarmstrong.com



Client  
**Stratherrick and Foyers Community Trust**

Project  
**Village Hall & Changing Rooms**

Project No. 1863

Drawing No. 00\_100

Revision

Proposed Floor Plans

Status  
Information

Date Created 09/21/17 Drawn by RG

Scale 1 : 100 Sheet @ A2